



**3 The Paddock Willows Riverside Park, Windsor, Berkshire, SL4 5UU**  
**£225,000**

 **HORLER**

### 3 The Paddock Willows Riverside Park, Windsor, Berkshire, SL4 5UU

Located on Willows Riverside Park, this charming two-bedroom park home offers a delightful retreat for those aged over 50. Located to the west of Windsor, the property enjoys a picturesque setting on the banks of the River Thames, providing a tranquil atmosphere while remaining conveniently close to local amenities and transport links.

Call today on 01753 621234 to arrange a viewing.



### Property Summary

Located on Willows Riverside Park, this charming two-bedroom park home offers a delightful retreat for those aged over 50. Located to the west of Windsor, the property enjoys a picturesque setting on the banks of the River Thames, providing a tranquil atmosphere while remaining conveniently close to local amenities and transport links.

Upon entering, you are welcomed into a dual aspect open plan living and dining room, which is bathed in natural light, creating a warm and inviting space for relaxation and entertaining. The separate kitchen is well-appointed with a range of eye and base level units, complemented by integral appliances that make cooking a pleasure.

The property boasts two generously sized double bedrooms, both featuring fitted wardrobes and ample storage space. The main bedroom benefits from an ensuite shower room, ensuring privacy and convenience, while a separate shower room serves the second bedroom and guests alike.

Outside, the park home is surrounded by a wrap-around south facing garden, offering a paved area to the side and rear, perfect for outdoor dining or simply enjoying the fresh air. A metal shed along the back fence provides additional storage, while the front of the property features hard standing parking for one vehicle and a well-maintained lawn.

This well-presented park home is an ideal choice for those seeking a peaceful lifestyle in a beautiful setting, with the added benefit of being close to the vibrant town of Windsor. Don't miss the opportunity to make this lovely property your new home.

### General Information

Council Tax Band 'A'

Over 50s only

No cats or dogs

Pitch Fee /Ground Rent: £265

Double Unit 36' x 20'

### Legal Note

\*\*\*Although these particulars are thought to be materially correct their accuracy cannot be guaranteed and they do not form part of any contract\*\*\*





# The Paddock SL4

Approximate Gross Internal Floor Area = 65.1 sq m / 700 sq ft

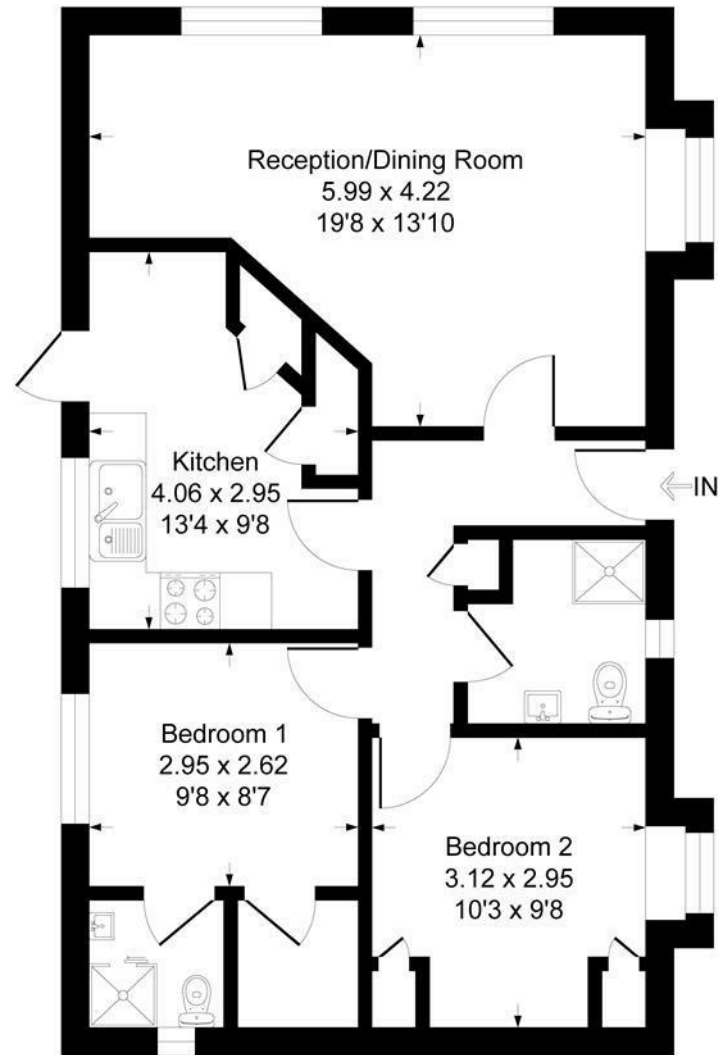

Illustration for identification purposes only, measurements are approximate, not to scale.  
Produced By Esjay Property Marketing